



PROVIDING ENERGY EFFICIENT  
LIGHTING SOLUTIONS

# LED RETROFIT KIT For Wallpack

Energy Focus, Inc.  
holds utility  
**Patent # US  
7,182,484 B2**  
protecting this  
product

- Directional LED module efficiently delivers the most usable light on target
- Patented thermal management system\*
- Easy to install retrofit kit fits many standard wallpack fixtures
- Autoranging voltage; 100-277 VAC
- Easily pivots on bracket for optimal positioning
- Rated life of 50,000 hrs to 70% lumen maintenance
- Listed on Design Lights Consortium Qualified Product List
- LTL tested in accordance with LM-79 standards for electrical and photometric measurements of LED fixtures
- Bridgelux LED array tested in accordance with LM-80 standards for measuring lumen maintenance of SSL sources
- Standard 5 year warranty

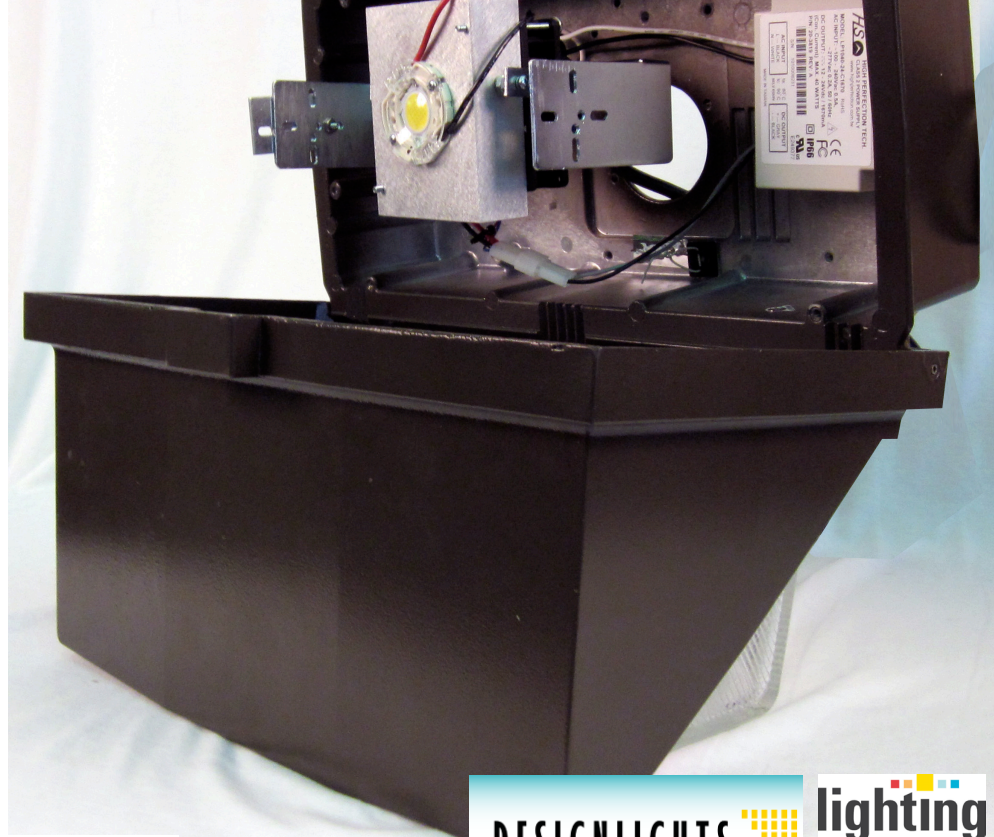

\*Patent # US 7,182,484 B2

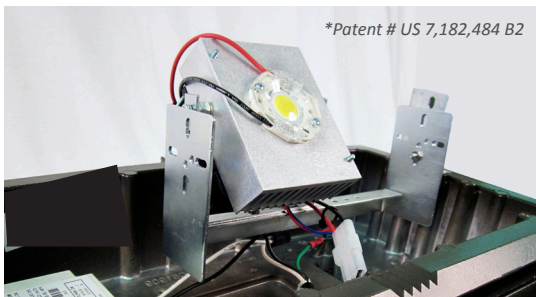

## Reduce Your Energy Consumption Dramatically

The Energy Focus LED Retrofit Kit for Wallpacks offers a fast and easy method of upgrading existing area lighting fixtures without the added cost of purchasing new fixtures.

Our LED Retrofit Kit for Wallpacks uses high output LED technology rated to 50,000 hour life to eliminate maintenance associated with those hard to reach luminaires. The kit installs inside your existing fixture keeping your look the same while reducing your energy consumption dramatically.

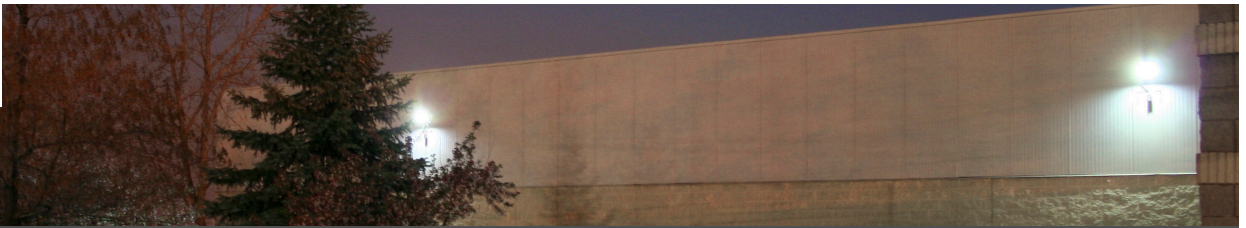

Energy Focus' products comply with the Buy America Act and are manufactured in the North American Free Trade Zone.

**SPECIFICATIONS**

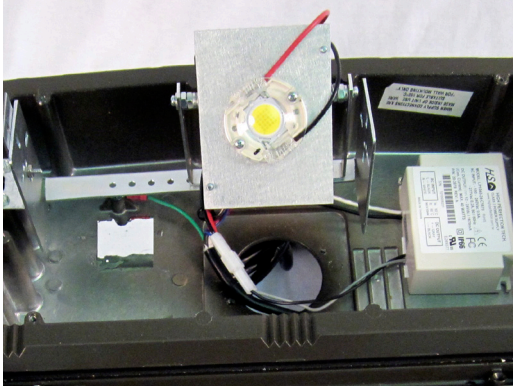

Adjustable bracket ensures LED module is centered inside luminaire

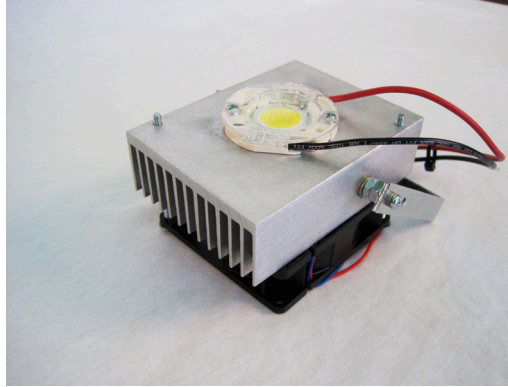

Patented active cooling system ensures optimal performance in up to 50°C ambient temperature

eLED

**lighting facts**<sup>®</sup>  
A Program of the U.S. DOE

<b>Light Output (Lumens)</b>	<b>2073</b>
<b>Watts</b>	<b>29.44</b>
<b>Lumens per Watt (Efficacy)</b>	<b>70</b>
<b>Color Accuracy</b> Color Rendering Index (CRI)	<b>64</b>
<b>Light Color</b> Correlated Color Temperature (CCT)	<b>5734 (Daylight)</b>

All results are according to IESNA LM-79-2008: Approved Method for the Electrical and Photometric Testing of Solid-State Lighting. The U.S. Department of Energy (DOE) verifies product test data and results.

Visit [www.lightingfacts.com](http://www.lightingfacts.com) for the Label Reference Guide.

Registration Number: BMBV-AC6J32 (10/13/2011)  
Model Number: LEDWP-656VFL-RFK  
Type: Outdoor wall pack

**Quick Installation Guide**

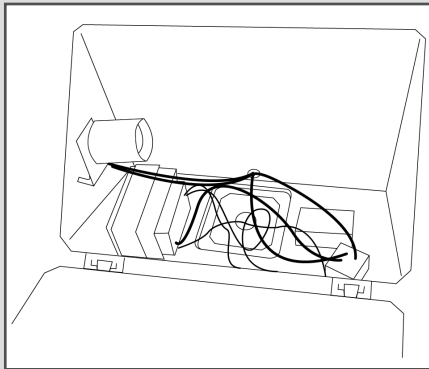

Open existing wallpack

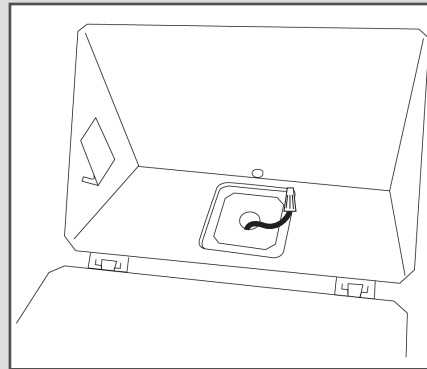

Remove all electrical components

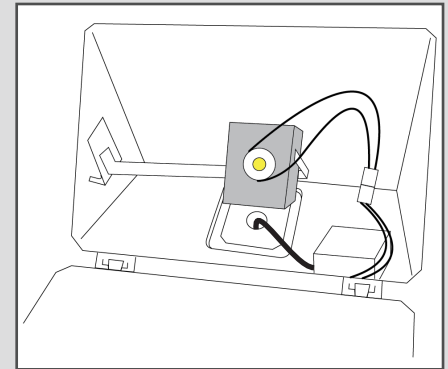

Install retrofit kit

**LED Retrofit Kit - Wallpack**

**Ordering Guide**

<b>Model</b> LEDWP	<b>Color Temp</b> 656 65 CRI, 5600K	<b>Beam Spread</b> VFL* 120° Beam	<b>Type</b> RFK Retrofit Kit
-----------------------	--	--------------------------------------	---------------------------------

\*Raw unit data; performance inside wallpack luminaire will vary